

Walraven RapidRail® Stainless Steel Wall Plate

(M2710)

fixing to wall, floor or ceiling

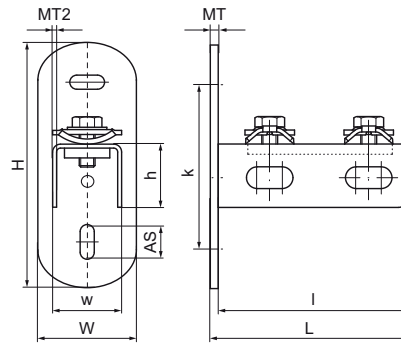

Features & benefits

- flexible base plate for rails
- for fixing to wall, floor or ceiling
- rail can be fixed with slot downwards or sideways
- suitable for rail WM1, 15, 2
- with pre-assembled Walraven RapidRail® Sliding nut(s) for a quick fixing, and retains assembly in place before final tightening
- material: stainless steel 1.4401/1.4404 (A4) - EN10088, AISI 316/316L; spring(s) made of of POM (polyoxymethylene), blue (according to RAL 5015)

| Product Number | VVS Number | For Rail Type | Total Height | Total Width | Total Length | Width | Height | Length | Heart To Heart Distance | Anchoring Slot | Material Thickness | Material Thickness 2 | Maximum Allowed Load Faz |
|------------------|------------|---------------|--------------|-------------|--------------|-------|--------|--------|-------------------------|----------------|--------------------|----------------------|--------------------------|
| Reference letter | | | H | W | L | w | h | l | k | AS | MT | MT2 | F _{0,z} |
| Unit description | | | mm | mm | mm | mm | mm | mm | mm | mm | mm | mm | N |
| 6617210 | 018041173 | 30x15, 30x30 | 123 | 50 | 100 | 35 | 32 | 96 | 83 | 23.5x11 | 4.00 | 2 | 2,850 |