

Product data

Product code	VC05-0154	STK-code	1912074	EAN-code	6410019120745
Product name	OTL-connector 2xAl/Cu 2,5-35mm ² (Blue)			ETIM class	EC000897
Wires	2xAl/Cu 2,5-35 mm ²				

Technical data

Nominal current (IEC)	Cu	270	A
	Al	120	A
Nominal voltage (IEC)	1000 V AC / 1500 V DC		
Max. Current (US)	Cu	2x115	A
	Al	90	A
Max. Voltage (US)	1000 V		
Number of poles	1 pcs		
Max. Cross section	35 mm ²		
Tightening torque	-		
	2,5-16 mm ² (6-14 AWG)	3	Nm
	25-35 mm ² (2-4 AWG)	6	Nm
Min. installation temperature	+5 °C		
Operating temperature	-25...+80 °C		
Weight	44 g		
IP-protection	IP20		
Standards	EN 61238-1:2003; EN 60947-7-(1-2):2009; UL1059 & CSA C22.2 No. 158-10		
Color / Material	Blue RAL 5015/ PA66-V0		
Mounting / Connection	DIN-rail mounting		

Description

OTL-connectors are designed for connecting and branching aluminium and copper conductors. The body is made of tin plated aluminium. Housing is made of UL94 V0 class polyamide. Made in Finland.

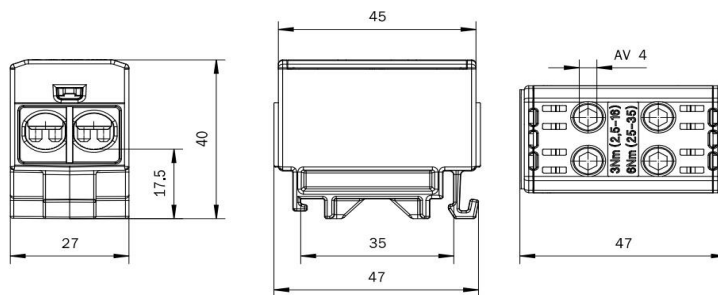
Drawing

Package

Package	Box	Pcs / Package	30	Weight [kg]	1,40
Length [mm]	165	Width [mm]	110	Height [mm]	150

Ouneva Oy

Teollisuustie 21
FI-82730 Tuupovaara
Finland

www.ounevagroup.fi

www.ounevaproducts.fi