

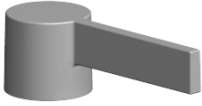













**Lever - Brushed Champagne (22kt Gold)**

**SPARE PARTS**

90 20 86 004 00 Product version from 4/1/2025



	Brushed Champagne (22kt Gold)	90 20 86 004 00-46
	Chrome	90 20 86 004 00-00
	Brushed Platinum	90 20 86 004 00-06
	Platinum	90 20 86 004 00-08
	Durabronze (23kt Gold)	90 20 86 004 00-09
	Dark Chrome	90 20 86 004 00-19
	Brushed Light Gold (PVD)	90 20 86 004 00-27
	Brushed Durabronze (23kt Gold)	90 20 86 004 00-28
	Matte Black	90 20 86 004 00-33
	Brushed Dark Brass (PVD)	90 20 86 004 00-39
	Brushed Bronze (PVD)	90 20 86 004 00-42
	Champagne (22kt Gold)	90 20 86 004 00-47
	Brushed Chrome	90 20 86 004 00-93
	Brushed Dark Platinum	90 20 86 004 00-99



## Lever - Brushed Champagne (22kt Gold)

SPARE PARTS

---

90 20 86 004 00 Product version from 4/1/2025



## Lever - Brushed Champagne (22kt Gold)

SPARE PARTS

---

90 20 86 004 00 Product version from 4/1/2025

90 20 86 004 00 Product version from 4/1/2025

Parts for other finishes can be found here: [Chrome](#)

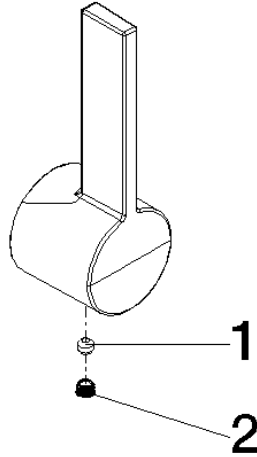

### Spare parts list

No.	Item Number	Name	Quantity used	Delivery time
1	90 31 11 063 00 90	Mounting Threaded pin with hexagon socket with cup point M5 x 4 mm -	1.00	14
2	90 31 20 109 00 90	Plug -	1.00	14