

EAN: 4015474598287  
[static.hansa.com/02200100](https://static.hansa.com/02200100)

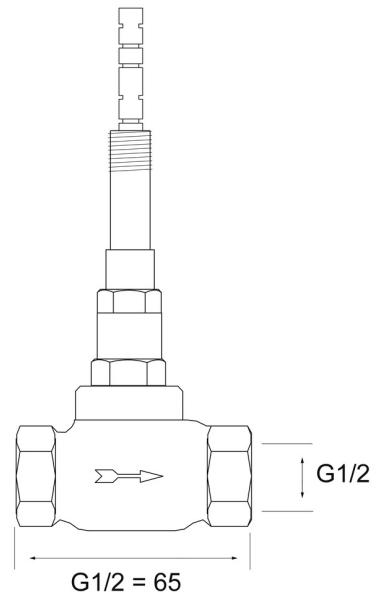

- Hulpuitrustingen
- Wandmontage voor inbouwunit
- Niet keramisch bovendeeel voor debiet
- Kraanhuis gemaakt van DZR messing

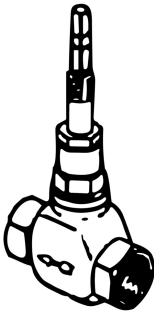

## Technische gegevens

### Doorstromingseigenschappen

Doorstroomhoeveelheid bij 3 bar **30.0 l/min**

### Technische eigenschappen

DN-maat **DN15**  
 Warmwatertoevoer **max. +80°C**  
 Werkdruk **1-10 bar**  
 Aansluitmaat **G1/2**

### Voorschriften

EN-norm **EN 200**

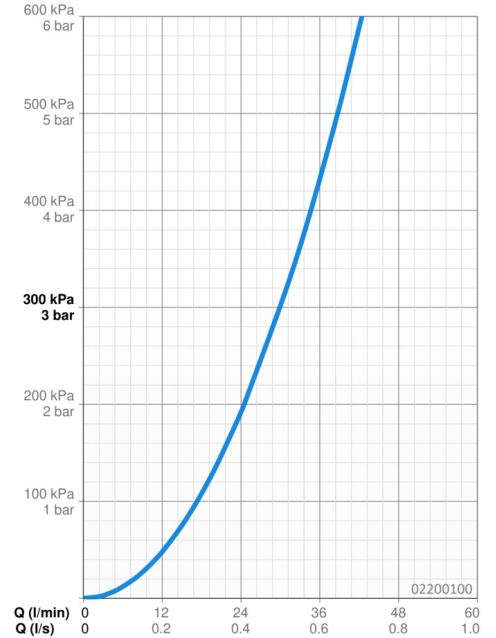

## Reserveonderdelen

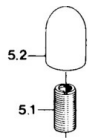

### Unterputzventil DN 15 (G 1/2)

mit Gewindeanschluß DN 15:

Einbauteilen:

von 10 bis 45 mm  
 45 bis 80 mm  
 80 bis 115 mm

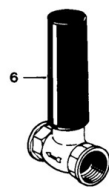
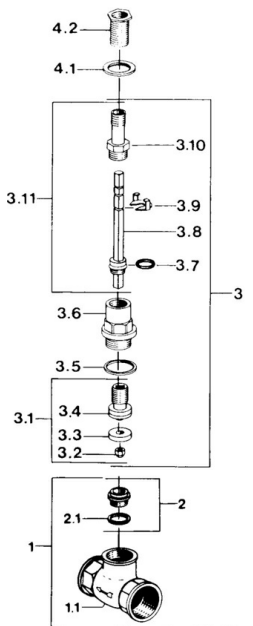

### SP02200100

|      | Naam   | Code     |
|------|--|----------|
| 1    | Body Stopgezet                               | 59902011 |
| 2    | Zetel, DN15, R1/2                            | 59904616 |
| 2.1  | Dichting, 18.5x15x1.5                        | 59902314 |
| 3    | Binnenwerk, 10-45 mm, G1/2                   | 59902723 |
| 3    | Binnenwerk, 80-115 mm, G1/2                  | 59901451 |
| 3    | Binnenwerk, 45-80 mm, G1/2                   | 59902726 |
| 3.1  | Klep Stopgezet                               | 59904956 |
| 3.3  | Afdichtring                                  | 59902301 |
| 3.5  | Dichting, 25x21x2 Stopgezet                  | 59902319 |
| 3.7  | O-ring, d 9.25x1.78                          | 59902338 |
| 3.8  | Spindel, 10-45 mm Stopgezet                  | 59902695 |
| 3.8  | Spindel, 45-80 mm Stopgezet                  | 59902697 |
| 3.9  | Veerklem                                     | 59901017 |
| 3.10 | Schroefdraad tepel Stopgezet                 | 59902620 |
| 3.11 | Inbouwverlengstuk compleet, L=150 Stopgezet  | 59902701 |
| 3.11 | Inbouwverlengstuk compleet, 45-80 mm         | 59905576 |
| 3.11 | Inbouwverlengstuk compleet, 80-115 mm Chromo | 59905577 |
| 4.1  | Kartelmoer                                   | 59902621 |
| 4.2  | Schroefdraad tepel, M12x1/M15x1, AF17        | 59902708 |
| 5.1  | Schroefdraad tepel                           | 59901373 |
| 5.2  |  | 59901106 |