

# — EN60, EN100

## End of Life Instruction

Decommissioning instructions available to enable responsible recycling or disposal



PREPARED 2024-08-05    Stefan Michel	DOCUMENT KIND EoL Instructions	SECURITY LEVEL Public		
OWNING ORGANIZATION ABB - ELSB	DOCUMENT ID. 9AKK108468A7015	REV. C	LANG. en	PAGE 1/5

# Contents

- 1. Purpose and Basic Description ..... 3**
- 2. Dismantling instructions ..... 3**
  - 2.1. More than 1 pole product:.....3
  - 2.2. 1 pole product:..... 4
- 3. Constituent materials ..... 5**
- 4. Additional Information..... 5**

# 1. Purpose and Basic Description

This product family is in the scope of European Union directive 2012/19/EU on Waste Electrical and Electronic Equipment (WEEE). The product family must be disposed according to the legislation of the country. This the end-of-life instructions is intended for use by customers and recycling companies which outline the responsible recycling or disposal method of the ABB product.

EN60 and EN100 MCBs are designed to be used in installations where 6kA (EN60) or 10kA (EN100) breaking capacities are required to protect against short-circuits and overloads.

## 2. Dismantling instructions

### 2.1. More than 1 pole product:

In case of more than 1 pole, first, the handle toggle<sup>(1)</sup> and the two marked rivets<sup>(2)</sup> should be removed to split the product into simple poles.

Then, there are some intermediate pieces that can then be easily removed<sup>(3)</sup>.

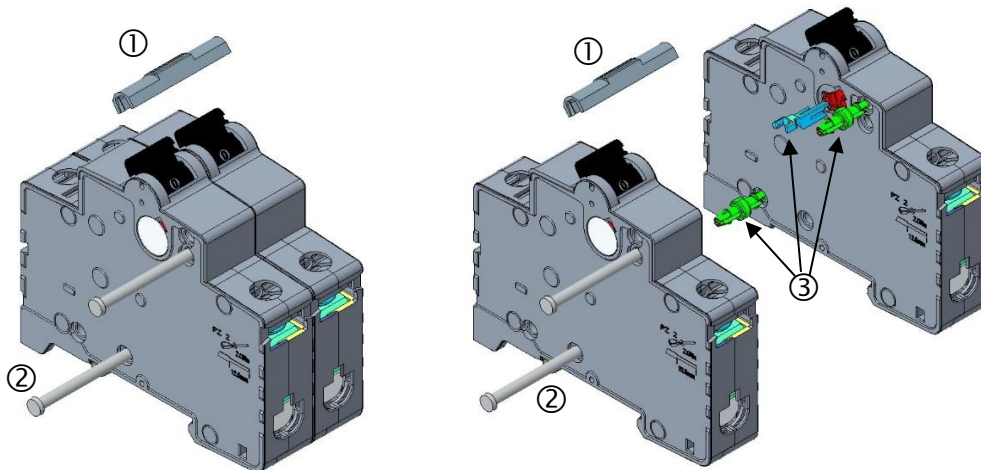

## 2.2. 1 pole product:

On that point, all single pole will be dismantling on the same way.

Firstly, removed the rivets (only 4 rivets left in products of more than 1 pole), then you will be able to take out the cover and access to all the internal parts.

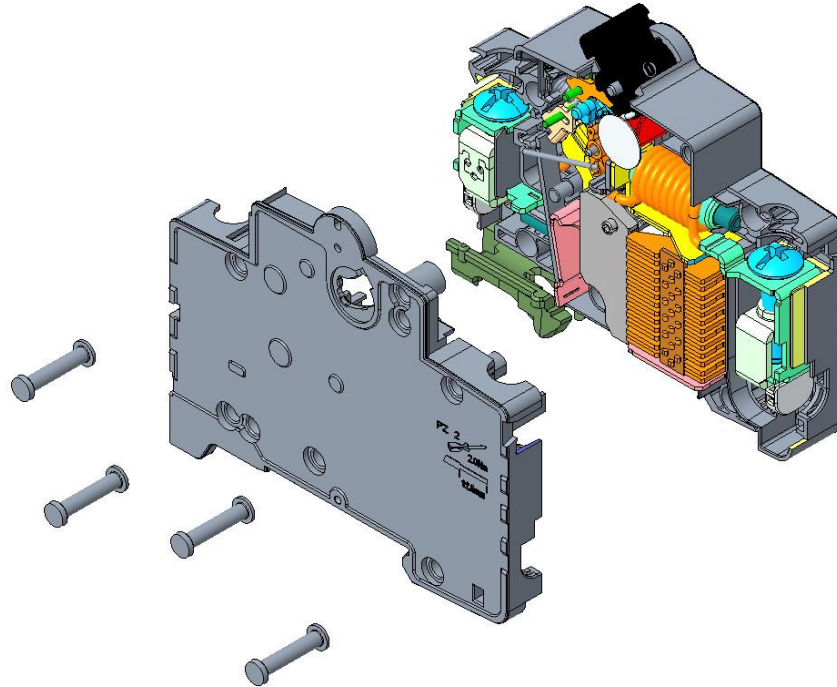

The different parts will be extracted until reaching the configuration of the figure below.

Rounded parts have soldered or riveted pieces that cannot be easily disassembled.

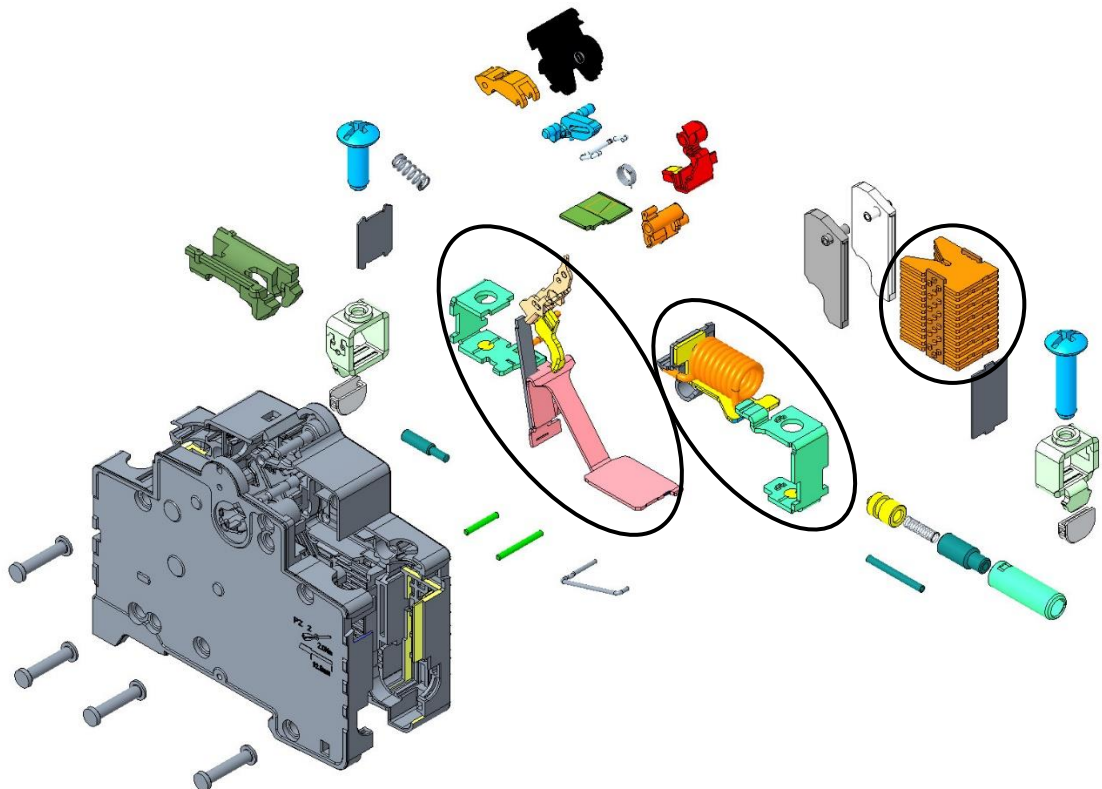

### 3. Constituent materials

Plastics		Metals		Packaging	
PA6/PA66	33.7%	Steel	51.5%	Cardboard	5.3%
POM	1.1%	Copper	4.4%	Others	0.1%
Others	0.9%	Aluminum	2.0%		
		Others	0.9%	<b>Others</b>	0.1%

Weight percentage of a single pole.

### 4. Additional Information

<b>Weight per Pole</b>	109,83g
<b>Overall dimensions (H x D x W)</b>	88 x 69 x 17.5 mm
<b>Recyclability rate</b>	50.0%