

## 17SKS-2605: Straight male adapter 26x3/4"

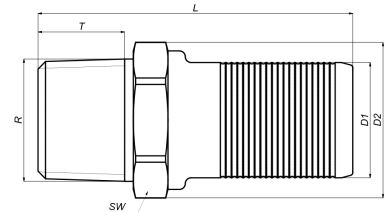

### Commercial information

The supply and feed-through of Henco plastic manifolds can be fitted with male (17SKS) or female (18SKS) straight adapters. These adapters are made from brass. Only combinations with Henco Vision push-fit fittings with a diameter of 20 or 26 mm are possible.

#### Basic unit dimensions

|            |          |
|------------|----------|
| Height     | 34 mm    |
| Length     | 56 mm    |
| Width      | 34 mm    |
| Net weight | 0.117 kg |

#### Certificates

KOMO

#### Applications

Potable water, Heating, Cooling, Sanitary

#### Solutions

Building installations, Industry, Utility

## Technical characteristics

|                                    |                                                       |                                  |                        |
|------------------------------------|-------------------------------------------------------|----------------------------------|------------------------|
| Material connection 1              | Brass                                                 | Bend radius                      | 0 Millimetre           |
| Material quality connection 1      | CuZn40Pb2 (CW617N)                                    | Outer pipe diameter connection 1 | 26 Millimetre          |
| Surface protection connection 1    | Untreated                                             | Length                           | 56 Millimetre          |
| Surface treatment connection 1     | Untreated                                             | Wrench width                     | 0 Millimetre           |
| Material connection 2              | Brass                                                 | Wrench width union nut           | 0 Millimetre           |
| Material quality connection 2      | CuZn40Pb2 (CW617N)                                    | Medium temperature (continuous)  | -10 70 Degrees celsius |
| Surface protection connection 2    | Untreated                                             | Max. operating pressure at 20 °C | 10 Bar                 |
| Surface treatment connection 2     | Untreated                                             | Standard Dimension Ratio (SDR)   | 0                      |
| Shape                              | Straight                                              |                                  |                        |
| Reducing                           | ✗                                                     |                                  |                        |
| Eccentric                          | ✗                                                     |                                  |                        |
| System specific                    | ✓                                                     |                                  |                        |
| Connection 1                       | Soldered end                                          |                                  |                        |
| Nominal diameter connection 2      | 3/4 inch (20)                                         |                                  |                        |
| Connection 2                       | External thread conical BSPT-R (ISO 7-1 / EN 10226-1) |                                  |                        |
| Main colour fitting                | Brass                                                 |                                  |                        |
| Material sealing                   | Ethylene-propylene diene monomer rubber (EPDM)        |                                  |                        |
| With buffer stud                   | ✓                                                     |                                  |                        |
| High tensile strength              | ✗                                                     |                                  |                        |
| With thermal insulation            | ✗                                                     |                                  |                        |
| Ring stiffness class               | Other                                                 |                                  |                        |
| With sealing rings/gaskets         | ✗                                                     |                                  |                        |
| Capped                             | ✗                                                     |                                  |                        |
| With drain valve                   | ✗                                                     |                                  |                        |
| With de-aerator                    | ✗                                                     |                                  |                        |
| FM quality mark                    | ✗                                                     |                                  |                        |
| LPCB quality mark                  | ✗                                                     |                                  |                        |
| ULC quality mark                   | ✗                                                     |                                  |                        |
| UL quality mark                    | ✗                                                     |                                  |                        |
| DIN-CERTCO certificate             | ✗                                                     |                                  |                        |
| VdS quality mark                   | ✗                                                     |                                  |                        |
| With approval for TÜV              | ✗                                                     |                                  |                        |
| DVGW quality mark for gas          | ✗                                                     |                                  |                        |
| DVGW quality mark for water        | ✗                                                     |                                  |                        |
| KIWA certified                     | ✗                                                     |                                  |                        |
| Gastec QA mark                     | ✗                                                     |                                  |                        |
| KOMO certified                     | ✓                                                     |                                  |                        |
| Type approval according to BBR/EKS | ✗                                                     |                                  |                        |