

28 796 710 Product version from 3/13/2017





- rain shower 300 x 240mm
- Rain shower material: metal
- PURE RAIN, max. flow rate 20 l/min (at 3 bar)
- Function from: 12 l/min

Technical data:

- quick clearing
- with anti-scale system
- distance between ceiling and lower edge of the shower 165mm
- rosette 78 x 55, as required
- 1/2" connection

Notes:

	Brushed Platinum	28 796 710-06
	Chrome	28 796 710-00

Recommended miscellaneous



- Concealed wall elbow -** 35 085 970 90
- min. recess depth 90 mm
 - max. recess depth 163 mm

28 796 710 Product version from 3/13/2017

mm [inches]

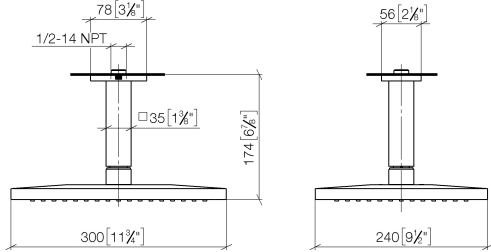

Flow rate chart

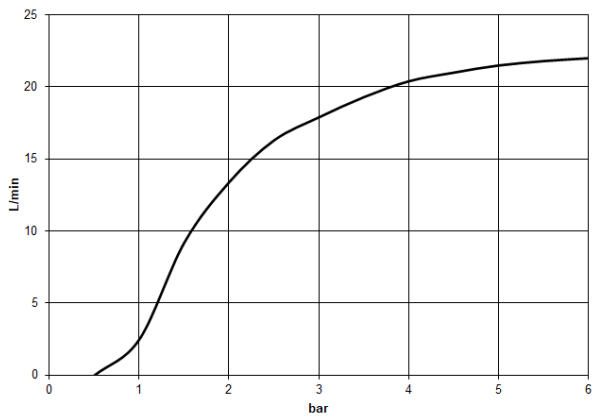

Codes & Standards

DIN 4109

ISO 3822

Scottish Water
Byelaws

UK Water Supply
Regulations

Ü-Zeichen



LULU Rainshower with ceiling fixing 300 x 240 mm - Brushed Platinum

LULU

28 796 710 Product version from 3/13/2017

Certificates and sustainability

LGA_29

LGA_38

WRAS_2212

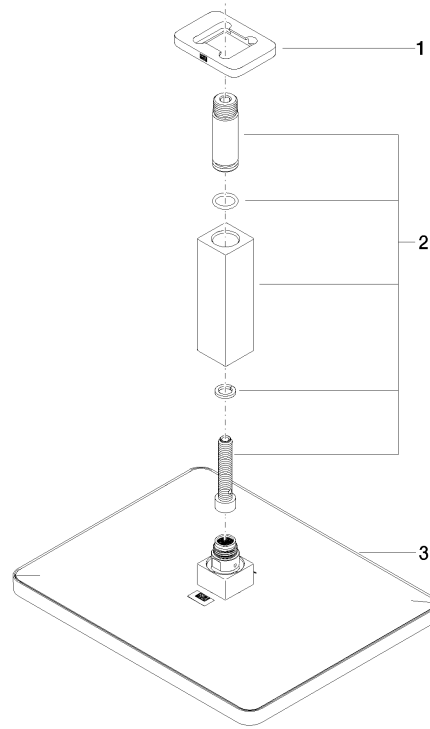

Spare parts list

No.	Item Number	Name	Quantity used	Delivery time
1	09 27 71 020-06	Rosette 78 x 55,5 x 9 mm - Brushed Platinum	1.00	20
2	90 11 10 092 00-06	Connection vertical for spray ceiling fixing 35 x 35 x 135 mm - Brushed Platinum	1.00	20
3	04 12 05 062 00-06	Rainshower angular G 1/2, 90° 300 x 240 mm - Brushed Platinum	1.00	20