

MP131-24T

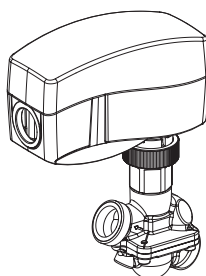

MP131-24MP +
VP228E, VP229E

Installation

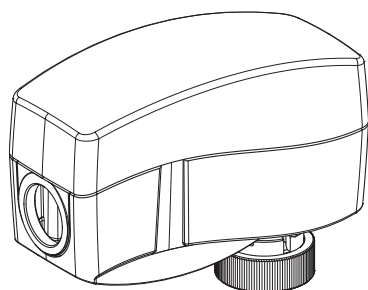

WARNING

AC 24 V

To avoid injury and damage to persons and devices, it is absolutely necessary these instructions are carefully read and observed prior to assembly and commissioning.

- Do not remove the cover before the power supply is fully switched off.
- Switch off the power line before wiring the actuator.
- Do not touch anything on the PCB.
- Connect via safety isolating transformer.
- Prior to assembly and maintenance work on the controller, the system must be:
 - depressurized
 - cooled down
 - emptied
 - cleaned

Failure to comply may lead to equipment damage or personal injury.

Necessary assembly, start-up, and maintenance work must be performed only by qualified, trained personnel.

Wire the actuator according to the wiring diagram.

Please comply with the instructions of the system.

Green position indicator (1):

The valve is open in this position.

The indicator moves down as the valve closes.

Mounting

The actuator should be mounted with the valve stem in either horizontal position or pointing upwards. Check the valve's neck. The actuator should be in stem up position (1) (factory setting). Ensure that the actuator is mounted securely on the valve body.

The actuator is fixed to the valve body by means of a ribbed nut which requires no tools for mounting. The ribbed nut should be tightened by hand.

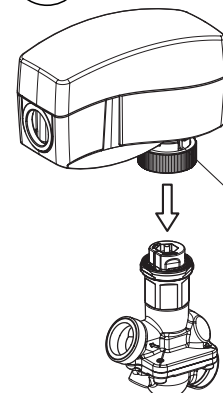
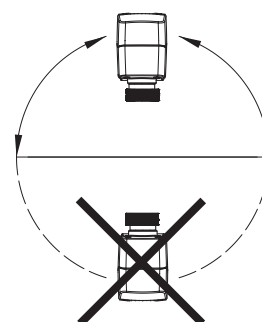
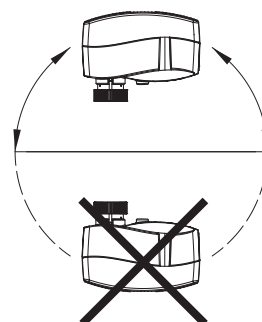

Green position
indicator



Wiring

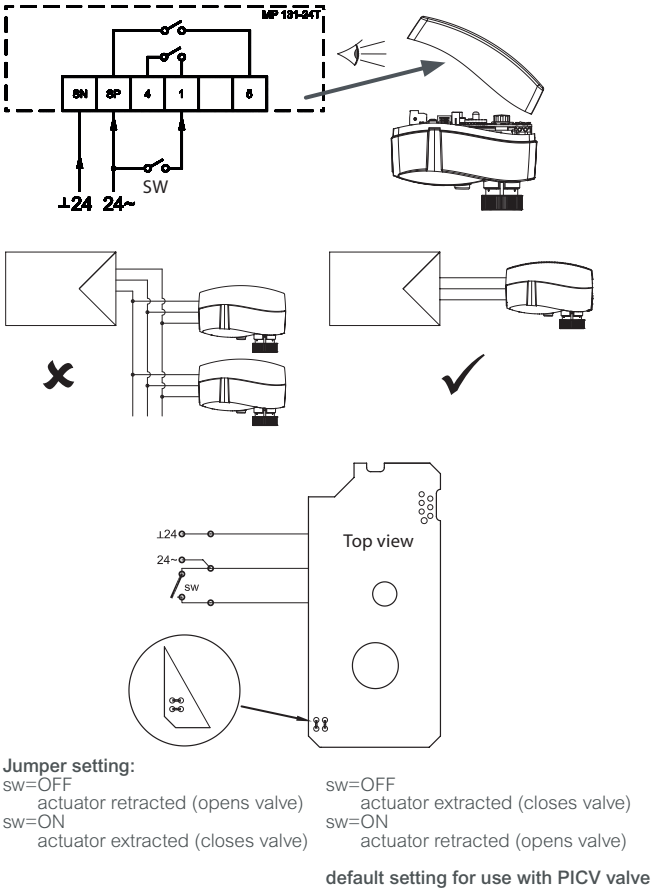

Installation

- a. Check the valve neck. The actuator should be in stem up position (factory setting). Ensure that the actuator is mounted securely on the valve body
- b. Energize the actuator according to the wiring diagram.
- c. The direction of stem movement can be observed on the position indicator (1).

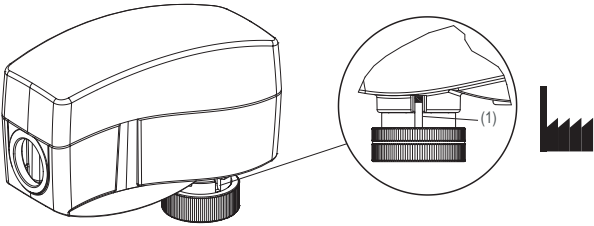

Manual Override

(for service purposes only)



WARNING

Risk of Equipment Damage or Personal Injury

- Do not manually operate the drive if power is connected.

Failure to comply may lead to equipment damage or personal injury.

- d. Remove cover (1)
- e. Press and hold the button (on the bottom side of the actuator) (2) during manual override (3)

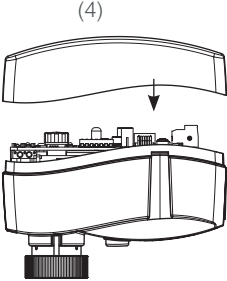
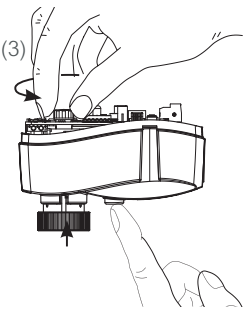
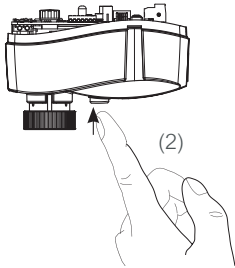
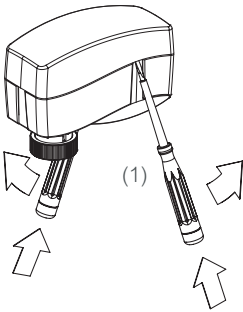

- f. Replace cover (4)
- g. Install actuator on valve

Note: A 'click' sound after is indicating, that the gear wheel has jumped into normal position.

Disposal Instruction



This product should be dismantled and its components sorted if possible, in various groups before recycling or disposal. Always follow the local disposal regulations.