

Walraven starQuick® Rail Adaptor

(C0550)

for use with Walraven starQuick® Rail

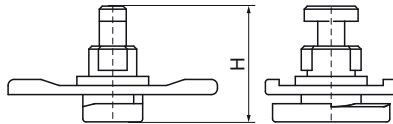
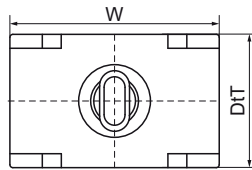

Features & benefits

- suitable for Walraven starQuick® clamp dimensions up to 32 mm
- for fixing of a Walraven starQuick® clamp (without nut) on a Walraven starQuick® Rail or on a Strut-Adaptor (Part No. 0854331)
- material: modified PA6 (polyamide), grey (according to RAL 7035)
- resistant to UV, ageing, oil and petrol
- no corrosion, recyclable, halogen free
- temperature resistance from approx. -40 °C to approx. +90 °C (constant); short to approx. +130 °C

Product Number	VVS Number	For Rail Type	Total Height	Total Width	Total Depth
<i>Reference letter</i>			<i>H</i>	<i>W</i>	<i>DtT</i>
<i>Unit description</i>			<i>mm</i>	<i>mm</i>	<i>mm</i>
0854313	018042900	27x18, 30x15, 30x20, 30x30, starQuick® Rail	19	35	22