

Concord

CONCORD BEACON 3000K WIDE SSC BLACK 2062503



Features

- Simple and slick integral design with no driver box and without any visible screws

New technology utilization for improved performance

Invisible in-track adaptor for an impressive architectural look

Extremely precise light beams due to the high-quality lenses

#80mm die-cast aluminium body, Fix beam angle: 55° , Textured black finishing colour

Light color temperature: 3000K, warm light

System power: 18W, Fixture lumen output: 1525lm, efficacy: 85lm/W, Ra97 typical, LED chromacity: 2 step MacAdam ellipse LED source (SDCM2), IR/UV free light source without heat radiation

Operating voltage 220-240V / 50-60Hz, electronic driver, dimmable via SylSmart

Standalone SSC Suitable for installation on 3-circuit tracks, please check compatibility list on the instruction sheet.

Compatible with OneTrack

Electrical protection: Class II. Degree of protection: IP20, suitable for indoor environment only

Horizontal rotation: 355°, vertical tilt: 90°

Nominal product dimensions: D.80mmx200mm

5 years warranty. Suitable for track mounting

Product Overview

Product name	CONCORD BEACON 3000K WIDE SSC BLACK
Technology	LED
Cap/Base	N/A
Housing	Aluminium
Mount	Track mounting
Fixture rating	Enclosed
General application	Museums & Galleries, Retail, Hospitality
ETIM Class	EC001744
Fixture luminous flux (lm)	1525

Concord

CONCORD BEACON 3000K WIDE SSC BLACK 2062503

Luminaire efficacy (lm/W)	85
LOR (%)	100
Correlated colour temperature (k)	3000
Light colour	Warm White
CRI (Ra)	97
Colour Variation Initial (SDCM)	2
Beam Angle (°)	55
Photobiological Risk Group	RG1
Total power consumption (W)	18
Electrical protection	Class II
Control gear type	LED driver constant current
Dimmable	Yes
Minimum dimming level (%)	1
Housing colour	RAL 9005 - Jet black
IP rating	IP20
IK rating	IK02
Product EAN number	5025768625031
Warranty	5 years
Dimming method	SylSmart SSC
Useful luminous flux (#use)	1475

Photometry

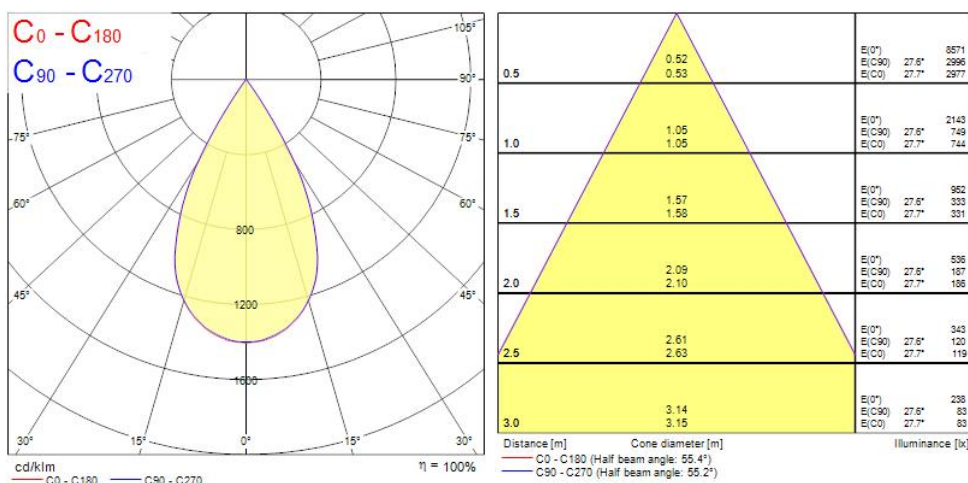

Concord

CONCORD BEACON 3000K WIDE SSC BLACK 2062503

Technical drawings

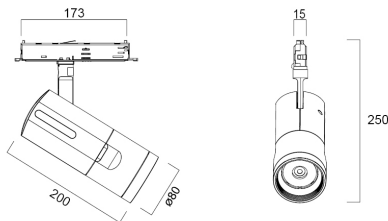

Data table

GENERAL DATA

Product name	CONCORD BEACON 3000K WIDE SSC BLACK
Technology	LED
Cap/Base	N/A
Housing	Aluminium
Mount	Track mounting
Fixture rating	Enclosed
General application	Museums & Galleries, Retail, Hospitality
Operating temperature range (°C)	-10°C...+35°C
ETIM Class	EC001744
Warranty	5 years

OPTICAL DATA

Useful luminous flux (#use)	1475
Fixture luminous flux (lm)	1525
Luminaire efficacy (lm/W)	85
LOR (%)	100
Correlated colour temperature (k)	3000
Light colour	Warm White
CRI (Ra)	97
Colour Variation Initial (SDCM)	2
Luminous Intensity (cd)	1525

Concord

CONCORD BEACON 3000K WIDE SSC BLACK 2062503

Beam Angle (°)	55
Distribution type	Symmetric
Photobiological Risk Group	RG1

ELECTRICAL DATA

Total power consumption (W)	18
Current (A)	0.082
Primary Supply/Product voltage - min (V)	220.0
Primary Supply/Product voltage - max (V)	240.0
Lamp power factor	0.9
THD (at 230 V, 50 Hz, full load, at 100% dimming level) \leq xx.x %	8.2
Electrical protection	Class II
Control gear required	No
Control gear type	LED driver constant current
Dimmable	Yes
Dimming method	SylSmart SSC
Minimum dimming level (%)	1
Drive current (mA)	500
Inrush Current (A)	20
Inrush Duration (μ s)	25
Glow Wire Test (°C)	650
Energy Efficiency Class (A->G) of contained light source	F
Nominal Frequency (Hz)	50/60Hz
Max. products per 10A C Breaker	50
Max. products per 13A C Breaker	104
Max. products per 16A C Breaker	136
Max. products per 20A C Breaker	166
Max. products per 10A B Breaker	50
Max. products per 13A B Breaker	62
Max. products per 16A B Breaker	80
Max. products per 20A B Breaker	100

LIFETIME DATA

Concord

CONCORD BEACON 3000K WIDE SSC BLACK 2062503

Lifespan L70 B50	100000
Lifespan L80 B50	100000
Lifespan L90 B50	56000

PHYSICAL DATA

Housing colour	RAL 9005 - Jet black
IP rating	IP20
IK rating	IK02
Diffuser finish	Other
Diffuser material	PMMA Acrylic
Reflector finish	None
Nominal Product Length (mm)	200
Nominal Product Width (mm)	80
Nominal Product Height (mm)	250
Nominal Product Diameter (mm)	80
Weight (kg)	0.94

PACKAGING

Product EAN number	5025768625031
Packaging single length / height (cm)	30.5
Packaging single width (cm)	13.5
Packaging single depth (cm)	20.5
DUN14 (inner)	05025768625031
Units per outer package	1
Packaging outer length / height (cm)	30.5
Packaging outer width (cm)	13.5
Packaging outer depth (cm)	20.5

SAFETY DATA

Optimal operating condition (°C)	-10-35
Special purpose lamp	No
Dry applications use only	Yes
Suitable for household illumination	No

Concord

CONCORD BEACON 3000K WIDE SSC BLACK
2062503
